

# Genesis United Methodist Church

Cascade Township, Michigan

## data

- new church facility / phased
- masterplanning and schematic design
- building area: 43,683 s.f. (phase 1)
- site area: 10 acres
- contractor: D&D Building
- cost: \$4-\$5 million (phase 1 estimate)



master plan site concept

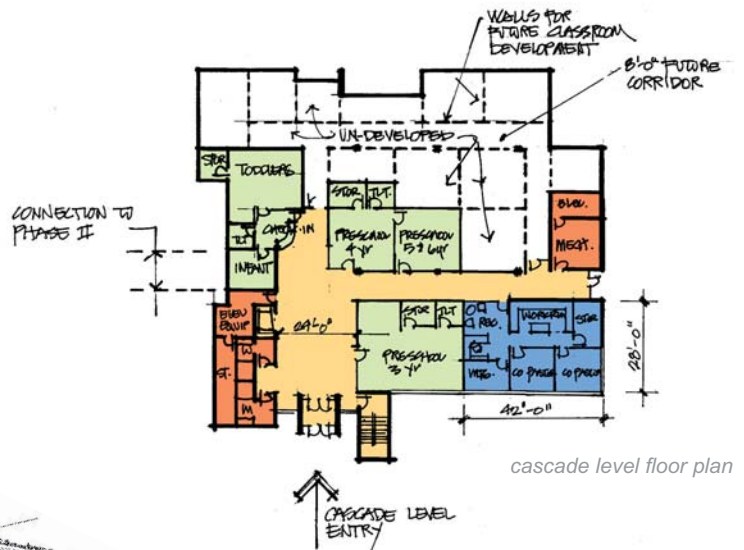

cascade level floor plan

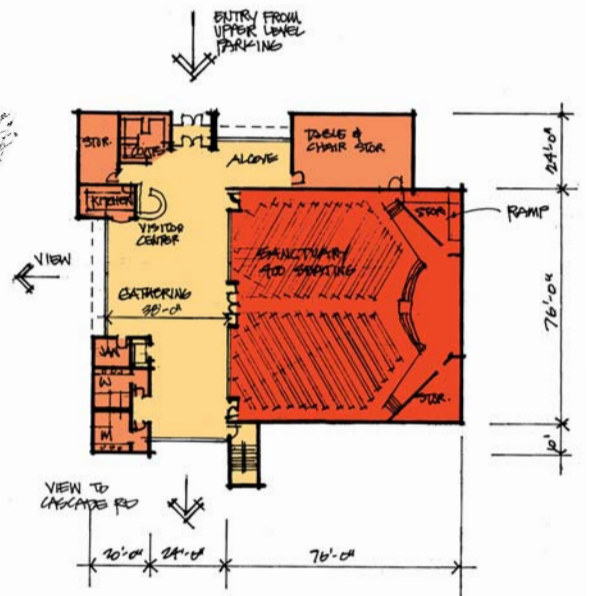

main level floor plan

## summary

Genesis United Methodist Church started as a seed church five years ago with a vision “to build a distinctively different community of faith by presenting the Gospel in such a creative and compelling way that persons become mature disciples of Christ.” This vision is the impetus behind the design of their new suburban church facility. The church will have a contemporary look and be built into the side of a heavily wooded, steeply sloped site, preserving as much of the natural setting as possible. This is a phased project which includes master planning, design and construction of a church facility containing a 500 seat auditorium which will be used for worship, drama and dance. Also included are classrooms for education, a gathering space, kitchenette, nursery and office. A.M.D.G. Architects coordinated the planning of this project with a Liturgical Consultant and also with the Kent County Road Commission and Drain Commission.