

# Inner City Christian Federation

Grand Rapids, Michigan

## data

- feasibility study
- completed: October 2001
- site area: 1.1 acres

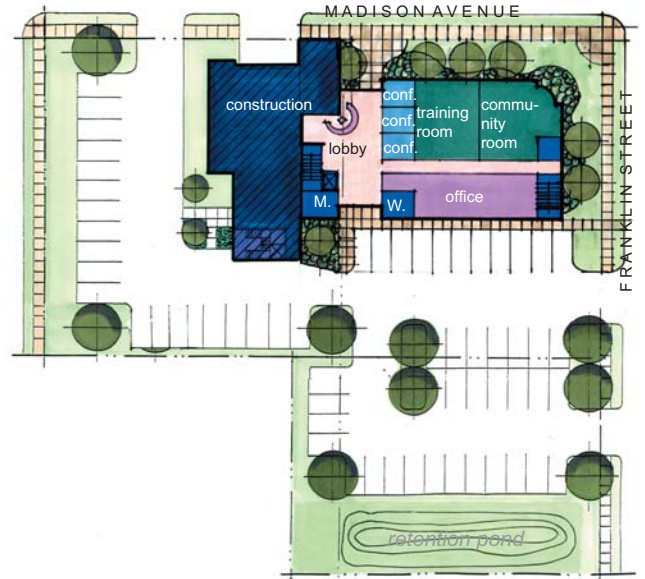
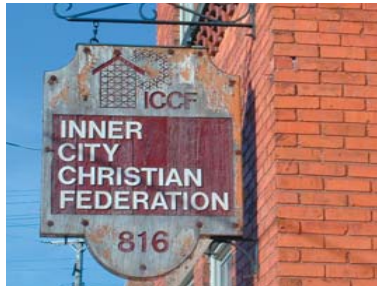

master plan



existing fire station at 816 Madison

## summary

Desiring a more efficient operation and wishing to make plans for future growth, ICCF sought to consolidate its organization, presently working out of two different locations, onto one site. In order to come up with the best plan for their needs, ICCF brought in A.M.D.G. Architects and Rockford Construction to do a feasibility study and give them informed recommendations on the pros and cons of several planning options. To begin this study, A.M.D.G. developed a program which included an analysis of the existing area of both facilities, a site analysis and projected growth figures. Following this came a design phase in which several options for consolidation and growth were presented along with their ramifications. Rockford Construction then developed conceptual budgets for each design option in order to evaluate the financial implications of each. Conclusions were reached and a recommendation presented to ICCF based on this study.